

PITUMEC

THE PCON 280 CONCENTRIC UNDERREAMING SYSTEM

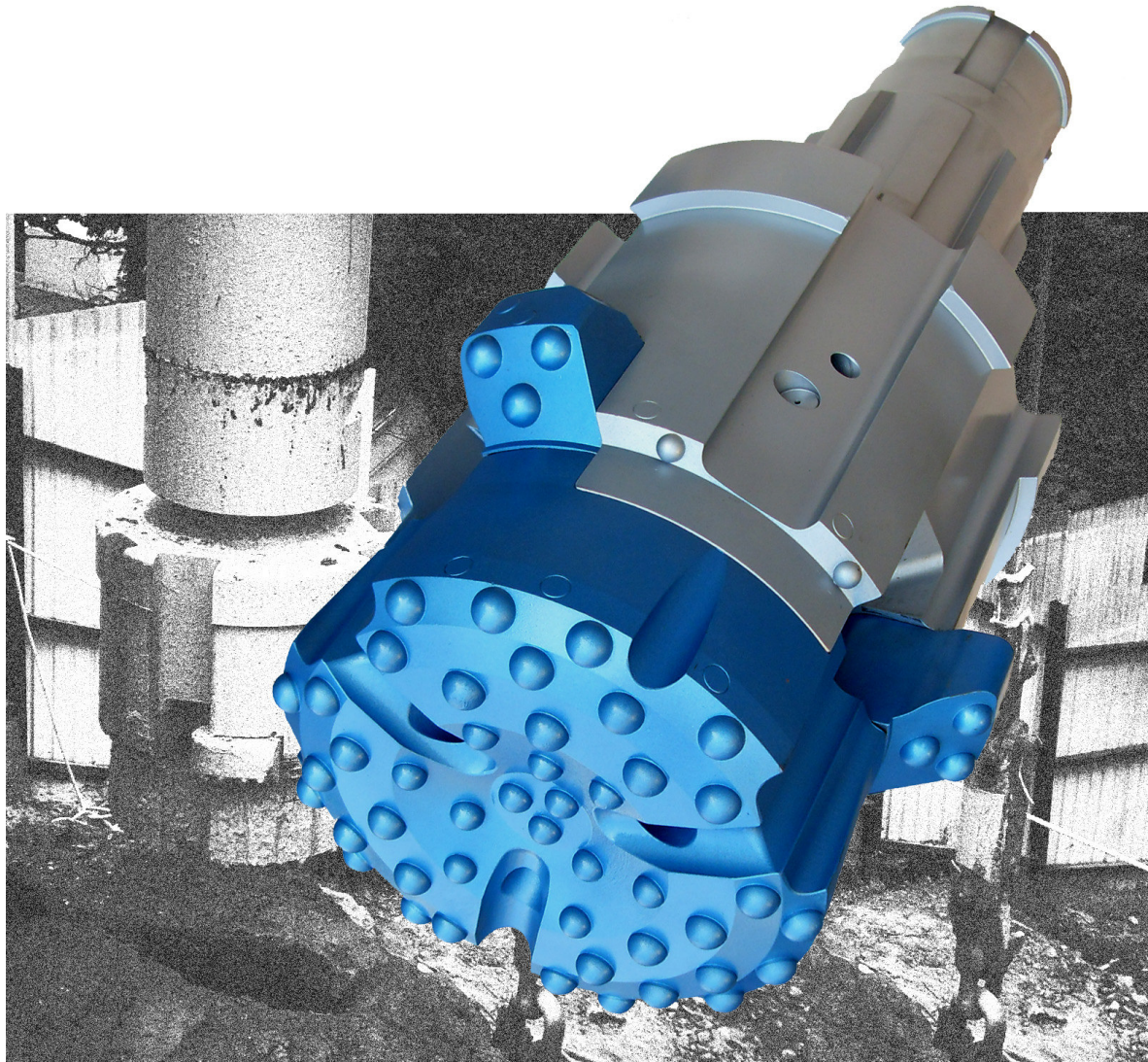

CASING SIZE 323MM OD X 302MM ID DRILLING DIA. 345MM

PNEUMEC PCON 280 CONCENTRIC UNDERREAMING SYSTEM

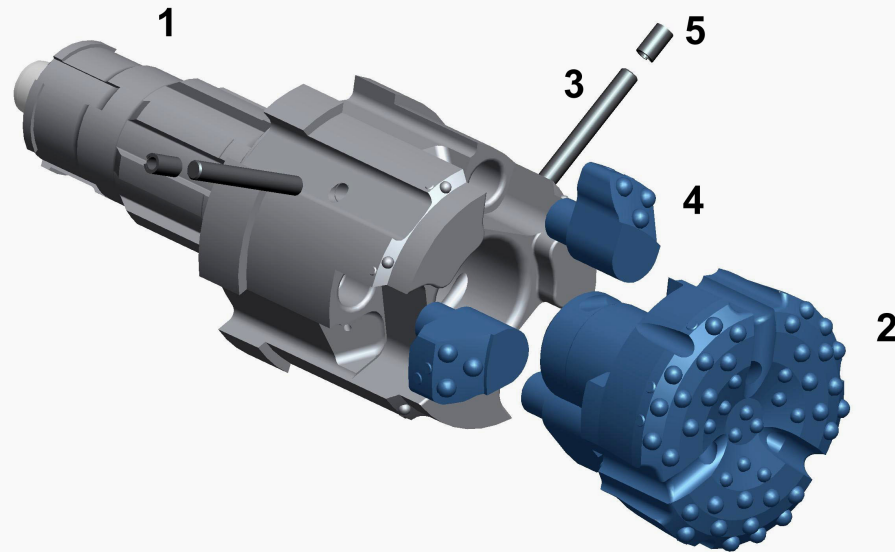

PCON 280 PARTS LIST

1.	GUIDE DEVICE SD10 SHANK	UGD280S10PCN
2.	PILOT BIT	UPB280PCN
3.	LOCKING PIN (2)	USP28050PCN
4.	REAMER (3)	UBS280PCN
5.	SPLIT PIN (2)	USP28051PCN
6.	COMPLETE SYSTEM SD10 SHANK	UCS280S10PCN

PCON 280 SPECIFICATIONS

UPPER BODY DIAMETER	300MM	CLOSED DIAMETER	280MM
REAMING DIAMETER	345MM	CASING SIZE	323MM OD X 302MM ID
SYSTEM LENGTH	740MM	SYSTEM WEIGHT	270KG

PCON 280 CASING SHOES

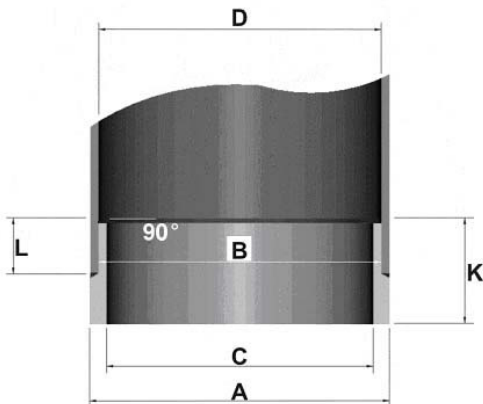

DIA. A	323MM
DIA. B	300MM
DIA. C	282MM
DIA. D	302MM
L	85MM
K	125MM

PNEUMEC

PNEUMEC COMPANY LIMITED

1st Floor, Tin On Sing Comm. Bldg., 41-43 Graham St. Central, H.K.

Tel : (852) 2180 9922

Fax : (852) 2180 9982

Website : www.pneumec.com

email : info@pneumec.com